

COMPACT, LIGHTWEIGHT AND EASY TO SETUP.

Compact and Versatile

- Patented, low profile machine is one of the most compact on the market today.
- Lightweight, weighing only 35 lbs (15.9 kg).
- Machine raised and flat flanges
- Bi-directional feed.
- Optional beveling head connects with "Quick-Lock" system, making changeover quick & easy.

Quality Components

- Pneumatic motor comes complete with filter, lubricator and flow control.
- Compact, low-profile drive system engineered for superior power to weight ratio.
- Features rugged main body, heavy-duty bearings, sealed lubrication, and rigid mounting system.

Cost Effective

- Cuts costs in four ways:
 - Reduces downtime
 - Eliminates off-site machining costs
 - Eliminates leak sealing procedures
 - Reduces stock of replacement flange
- Recoup the cost of a Climax Flange Facer in the first few flange facing jobs.

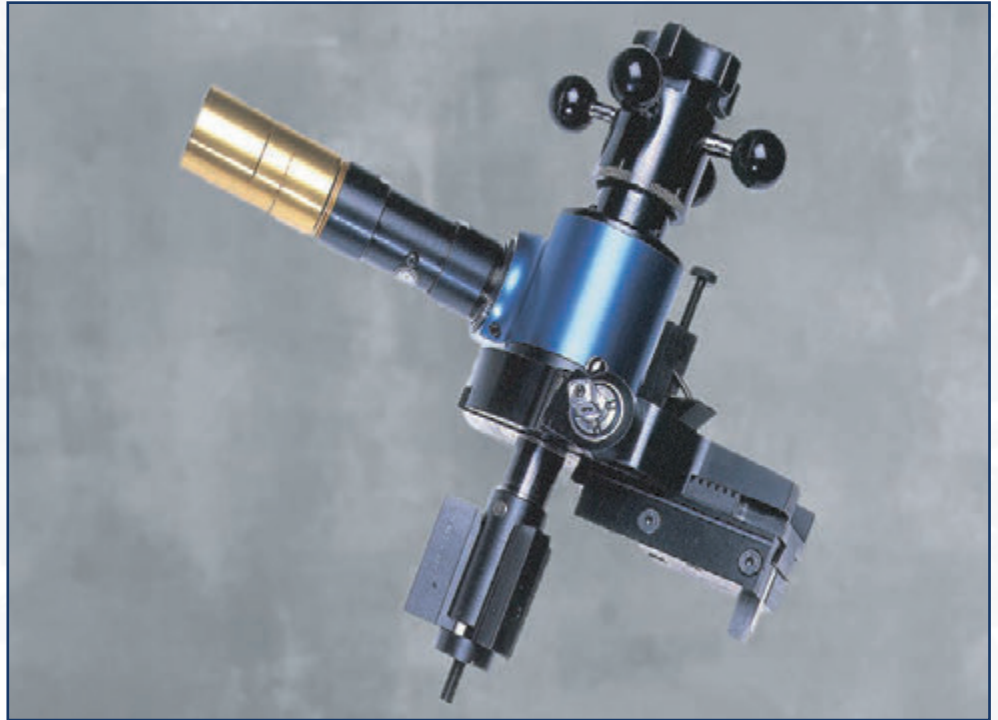

SPECIFICATIONS

	US	Metric
Flange Facing Diameter	1.5 - 12.0 inches	38.1 - 304.8 mm
Beveling Diameter (w/ optional beveling head)	2.0 - 7.0 inches	50.8 - 177.8 mm
Pipe Facing Diameter (w/ optional beveling head)	2.0 - 7.0 inches	50.8 - 177.8 mm
ID Mounting Diameter	1.5 - 6.86 inches	38.1 - 174.2 mm
Maximum radial travel of Chuck Ramps	0.23 inches	6 mm
Feed rate (reversible, variable)	0 to 0.025 inches/rev.	0 to 0.635 mm/rev.
Power, Pneumatic	0.79 Hp	0.59 kW
Power Requirement	36 cfm, 90 psi	1.02 m ³ /m, 629 kPa
Operating Weight	35 lbs	15.9 kg
Shipping Weight (Machine w/ Facing Head Only)	102 lbs	46.3 kg
Shipping Weight (Machine w/ Beveling Head Only)	95 lbs	43.1 kg
Shipping Weight (Machine w/ Facing & Beveling heads)	109 lbs	49.4 kg
Shipping Dimensions	32 x 21 x 11 inches	812.8 x 533.4 x 279.4 mm

TOOL CONFIGURATIONS

Configure your FF3000 in 2 easy steps.

To configure your FF3000 Flange Facer:

- 1 Select a Base Package
- 2 Select a Facing Head

To configure the flange facer you require, simply select the option you need in each step, then contact your Climax representative.

1 Base Package

Main machine with .79 Hp (0.59 kW) pneumatic motor with air conditioning unit, tooling, chuck, and chuck block set. Unit comes packaged in a durable molded container.

49592

2 Facing Head

12 inch (304.8 mm) facing head
7 inch (177.8 mm) beveling head

35222

34980

Optional Facing/Beveling Bits:

Facing bit
Beveling bit 37.5 degrees
Roughing tool bit
Finishing tool bit
5 degree chamfer tool bit

33141

33136

31867

31858

33315

Optional Facing/Beveling Heads:

Beveling head 7 inches (177.8 mm)	34980
Beveling head 12.75 inches (323.9 mm)	35439
Facing head, 1.5 - 12 inch (38.1 - 304.8 mm) diameter	35222
Facing head, 1.5 - 19 inch (38.1 - 482.6 mm) diameter	34936

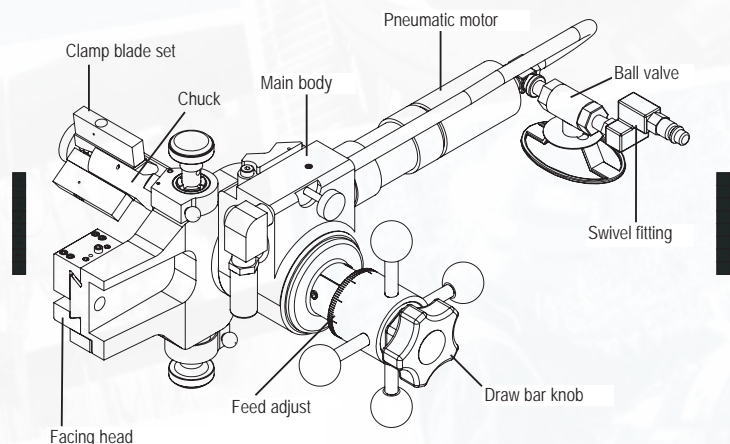

OPERATIONAL DIMENSIONS

Dimensions in Inch (mm)

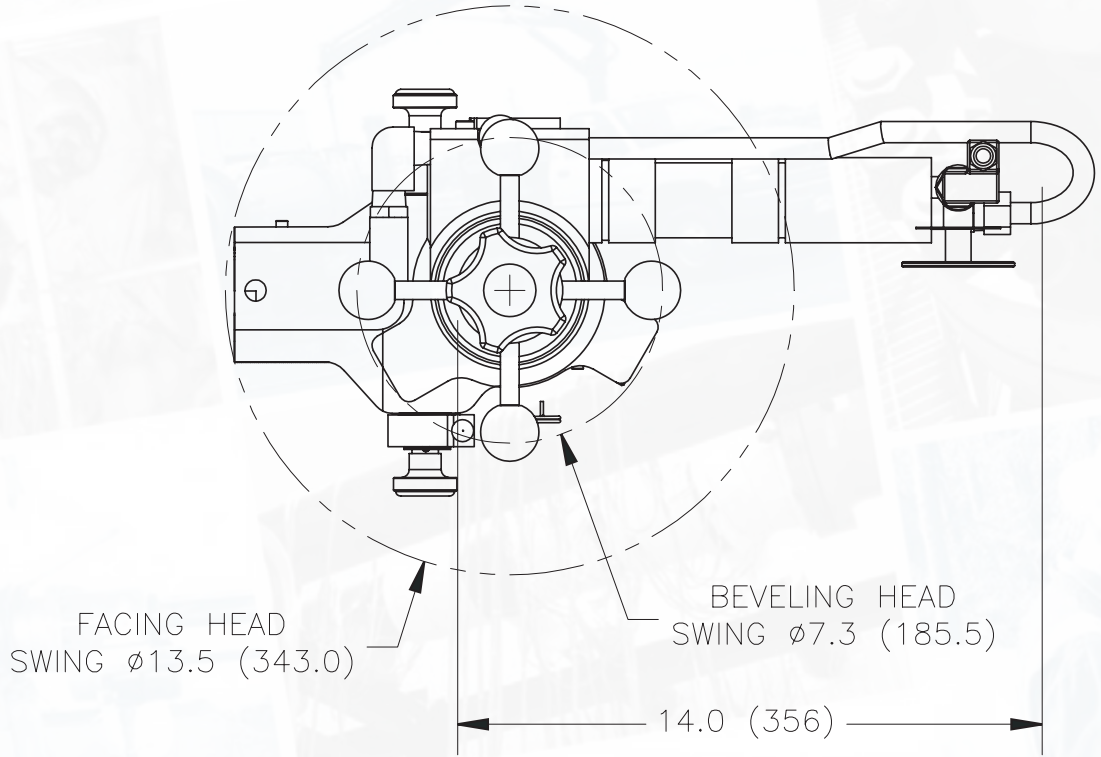
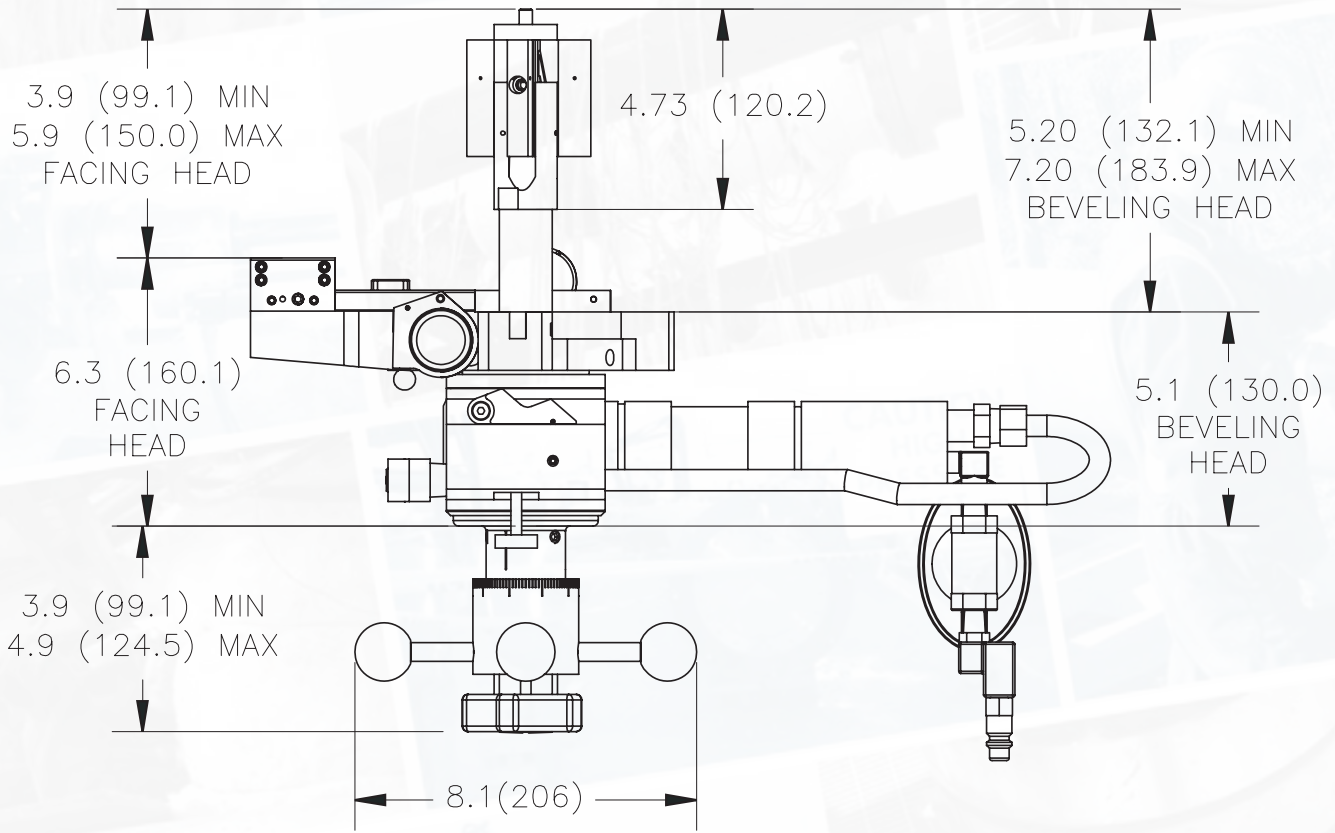

A Fast Five-Step Process

Setup of the FF3000 Flange Facer is quick and easy. The modular design and versatile setup options allow the chuck and main body to be set up separately.

An experienced operator can set up the machine in 10 minutes or less.

- 1** Choose from facing or beveling heads.
Place tool bit in tool slot and tighten set screw.



- 2** Align the 3 pin "Quick-Lock" system and tap with plastic mallet to seat.



- 3** Select jaw set according to the ID diameter that the machine will chuck into.



- 4** Place the machine in the bore. Hold to good start height, and tighten hand nut to snug. Push down on hand nut. While holding nut down, turn rod handle to tighten chuck.

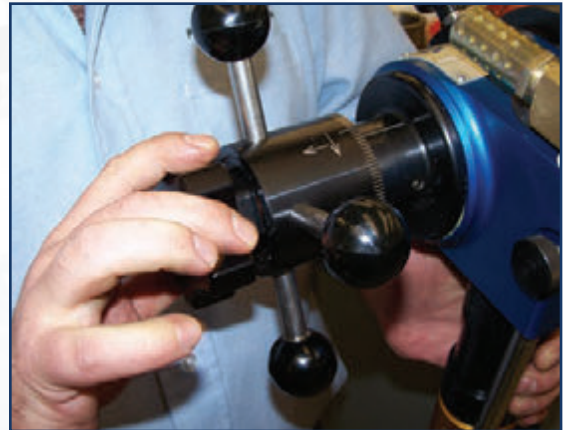

- 5** Set tool to desired cutting depth, and begin machining.

